

# QT604/M QUANTEC MONITORING POINT

## Wiring Instructions

PLK5 disables the Reset button when removed (this does not affect the Keyswitch)

If a normally closed switch is to be used, fit PLK2 to make the SW input active when open.  
If a normally open switch is to be used, remove PLK2 to make the SW input active when shorted.

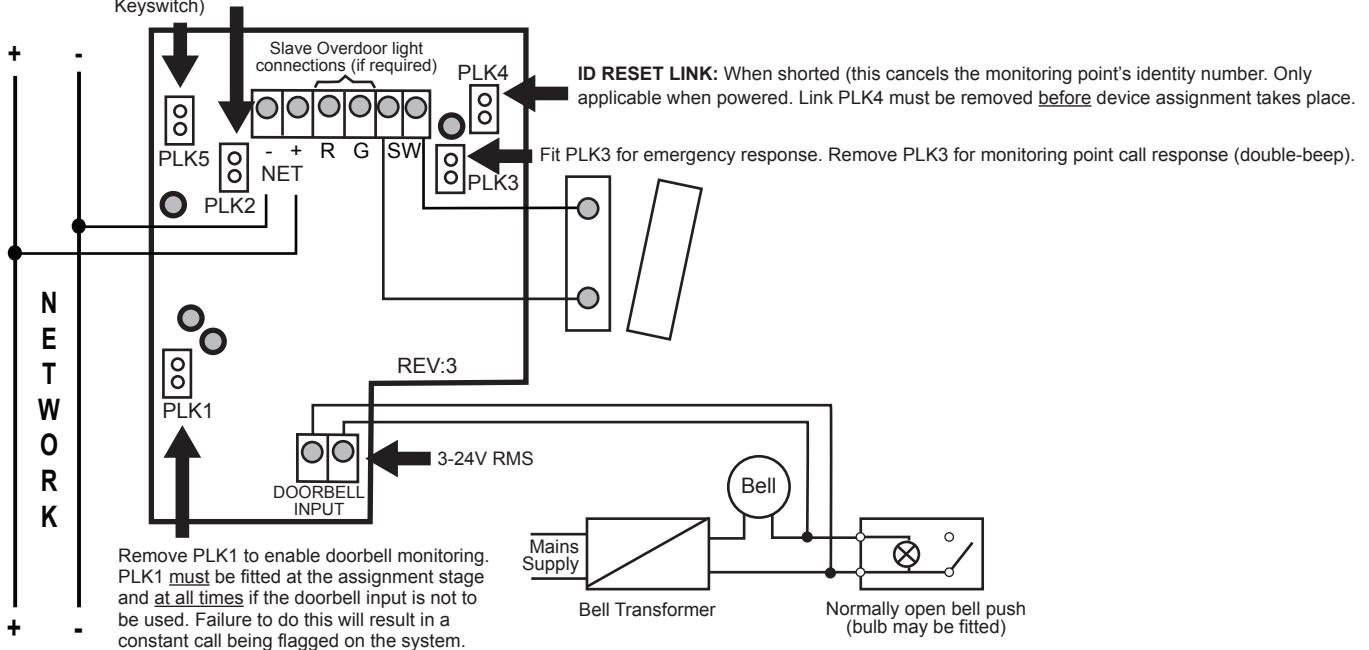

### OPERATION:

Momentarily opening or shorting the SW input will make a standard monitoring point call (double-beep) or an emergency call, depending on the status of links PLK2 and PLK3 (refer to diagram above).

To reset a call, either activate the Reset button (if PLK5 is fitted) or turn the keyswitch to isolate.

If the keyswitch is left in the isolated position, the device's LED will show Green and the SW input may be opened and closed without signalling a call on the system.

To change the level of call from standard to emergency, or vice versa, alter PLK3 as required and reset the system.

### TO GIVE THE DEVICE AN ID NUMBER:

(1) Decide on the level of call response required, i.e. standard call or emergency call. Fit the relevant links and ensure the SW Input is in the passive state and link PLK1 is fitted.

(2) Set the Network Controller to Assignment Mode (refer to the Quantec Programming Manual) and momentarily turn the keyswitch to isolate to assign the device.

(3) When an ID number has been assigned, the device will be recognised as a monitoring point (MNPT).

Please refer to the Quantec Programming Manual for further details on name and set assignments.

### TELEPHONE MONITORING

#### Application Note:

Telephone monitoring can be achieved via A Call Alert Unit (available from RS Components - Part No. 252-526).

Wire the monitoring point as shown in the diagram (right), ensuring that link PLK1 is fitted and PLK2 is removed. Plug the Call Alert Unit into the telephone socket you wish to monitor. NB The socket must be a master socket. When the telephone rings, a standard or emergency call will be shown on the Nursecall system, depending on if PLK3 is fitted or not (see above for further details).

Please note, the monitoring point cannot be reset whilst the telephone is still ringing.

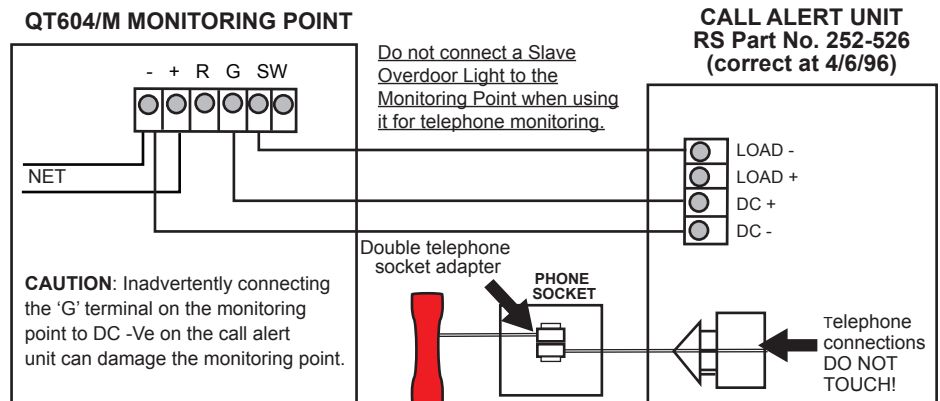

These instructions only apply to Monitoring Points with the legend Rev3 or later, on the PCB. Alternative instruction sheets are available for earlier versions. Contact your supplier for details.