

# CHALLENGER

## High Lumen LED PIR Floodlights 15w, 30w, 50w

Models: SLFLF15BP, SLFLF30BP, SLFLF50BP



SLFLF15BP



SLFLF30BP



SLFLF50BP

## Installation Manual

## **Introduction**

Thank you for purchasing your Challenger high lumen led floodlight, these instructions should be read carefully and retained for further reference and maintenance.

## IMPORTANT

- Installation must be carried out by a skilled electrician who is familiar with the appropriate standards and technical requirements of the appliance also taking in to consideration the latest building regulations.
- The person carrying out the installation is to check and verify that the total load on the circuit, including the rating of the cable, fuse and/or circuit breaker is not exceeded.
- Ensure there is adequate ventilation around the luminaire
- Ensure the AC mains supply is isolated when installing or servicing.
- This product must be earthed. 
- Once illuminated DO NOT look or stare at the LED fitting directly when in close proximity.
- Never modify the luminaire, there are no user serviceable parts inside.
- Please observe the installation/mounting height to ensure correct operation.
- The luminaire has a selectable wattage output (30w & 50W models only). **Please ensure that the correct wattage output** has been selected as this will have an impact on the lighting design to ensure the correct light levels are achieved.



## Specification

- High lumen output LED floodlights
- Slimline lightweight design
- 120° PIR with up to 10m detection distance
- Installation Height 2.0-2.8m
- Adjustable lux setting 3-1000lux
- Adjustable time delay up to 12 minutes
- Manual override (OFF/ON, OFF/ON), light on for 5 hours
- Polycarbonate encapsulated lens module
- Lumiled 2835 LED chip
- Pre-wired cable – 1m
- 90° x 120° beam angle
- 5000k Colour temperature
- IP65 ingress protection
- IK08 impact protection
- 50,000 hours rated life
- Input voltage – 100-277V AC 50/60Hz
- Power factor - PF≥0.9
- CRI rating - >70
- Operating temperature -20°~+40°c
- 5 year warranty
- Selectable wattage (SLFLF30BP & SLFLF50BP models only)

## Specification

Model	Lumens	Wattage	Dimensions (mm)	Input Current	Weight
SLFLF15BP	1950	15w	148x128x45	0.2A	0.58Kg
SLFLF30BP	3900, 2600, 1950, 1300	30w, 20w, 15w, 10w	216x190x50	0.37A	1.23Kg
SLFLF50BP	6500, 3900, 2600, 1950	50w, 30w, 20w, 15w	247x238x52	0.72A	1.62Kg

## PIR Function

- **Time adjustment:** Time can be adjusted between 8(±5) seconds and 12(±2) minutes. When adjusted to “-” position the time will be 8 seconds, when adjustable to “+” position the time will be 12 minutes. **Note:** When the PIR has timed out and switched the LED lamp off, there will be a short delay of 2 seconds before the sensor can be activated again.
- **Adjustable lux setting:** Move adjuster between  &  position to set lux, if moved to sun position, luminaire will work during the day & night, if moved to moon position, luminaire will work at night only (less than 20 lux).

- **Sensitivity adjustment:** Detection range can be adjusted between 5m & 10m approximately (this will be dependent on external factors such as mounting height, angle & background temperature). If adjusted to “-“ position, detection range will be approximately 5m, if adjusted to “+“ position, detection range will be up to 10m.
- **Manual override function:** To manually override the PIR, the fitting must be switched ON and in automatic mode. Then switch the AC supply via a wall switch, OFF-ON, OFF-ON (twice) within 2 seconds, the sensor will now hold the light ON continuously for 5 hours. After 5 hours the sensor will return back to the automatic mode.

To return the PIR back to automatic mode there are two methods:

1. Turn off the AC supply via a wall switch, then after 10 seconds, re-apply the AC supply via the wall switch, the PIR will then enter automatic mode.
2. Switch the AC supply via a wall switch, ON-OFF, ON-OFF (twice) within 2 seconds, the PIR will then enter automatic mode.

**PIR controls showing adjustable dials for time, lux and sensitivity**

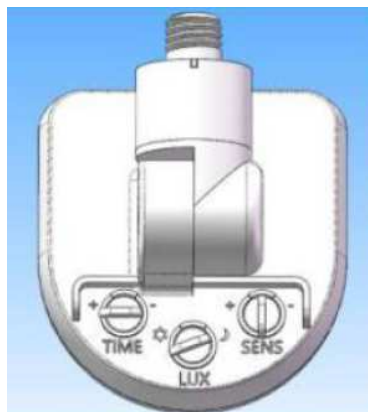

## Top view – detection angle



## Side view – detection distance

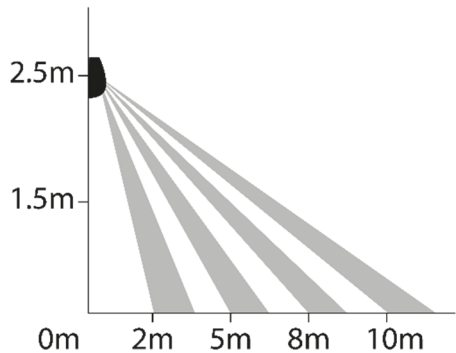

## Installation

- Ensure the electrical AC power is switched OFF before and during installation
- For the AC supply cable and connections, a cable that is rated to 90°C should be used
- The sensor is designed for optimum performance when mounted 2.0-2.8 meters above ground level
- To avoid nuisance triggering, the sensor should be directed away from trees, shrubs and flues, heat extraction units.
- The PIR Sensor range may vary slightly depending on the mounting height and location. The detection range of the unit may also alter with temperature changes (higher temperatures will result in reduced range). Before selecting a place to install the fitting you should note that movement across the sensor is more effective than movement directly toward or away from the sensor. If movement is made walking directly towards or away from the sensor and not across, the apparent detection range will be substantially reduced.
- Ensure the luminaire is securely fixed to a surface free from vibration

- When adjusting the angle of the fitting please ensure that there is enough slack in the cable so the range of movement of the luminaire is unhindered
- **Ensure that the correct wattage output** has been selected (30w & 50w models only) as this will have an impact on the lighting design to ensure the correct light levels are achieved.
- A suitable IP rated junction box is required for the premade AC electrical connections (Brown = Live, Blue = Neutral and Yellow/Green = Earth). This luminaire must be earthed
- Check the lighting fixture is firmly fixed and the Allen bolts have been inserted in to the bracket
- Check all the connections are wired and terminated correctly

**Adjust the wattage via dip switch** (please remove the screw on cap and replace)

**Ensure that the correct wattage output has been selected** (30w & 50w models only) as this will have an impact on the lighting design to ensure the correct light levels are achieved.

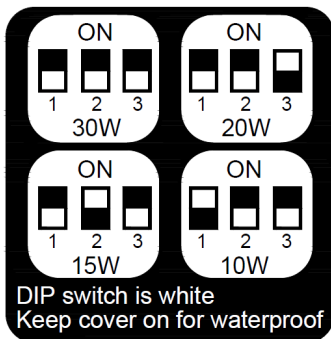

SLFLF30BP

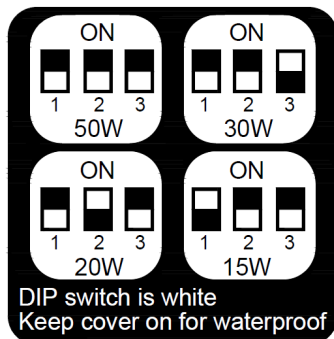

SLFLF50BP

Refer to the following diagram when you install the fixture.

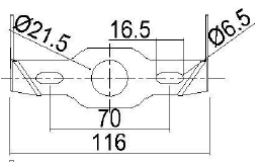

**SLFLF15BP**

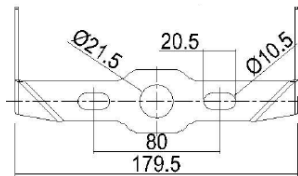

**SLFLF30BP**

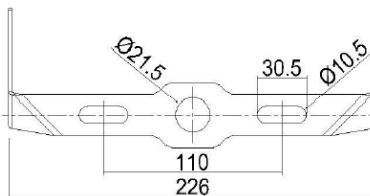

**SLFLF50BP**

1. Turn off the AC Supply  
Fix the luminaire bracket to the surface.
2. Keep enough slack in cable to ensure when adjusting the angle, the movement is unhindered
3. Connections- AC-Live: Brown, AC-Neutral: Blue, GND Earth: Yellow-Green.
4. Check the circuit and connections are correct prior turning on the AC supply

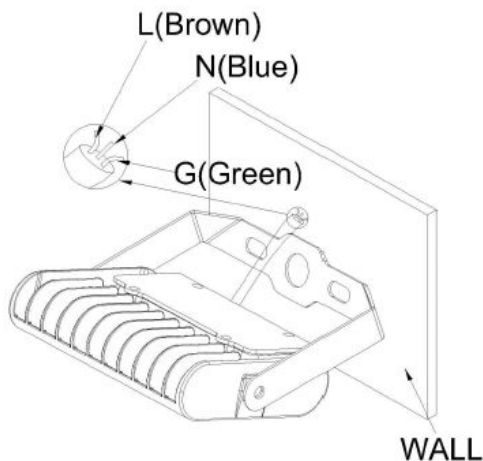

5. **Ensure that the correct wattage output** has been selected (30w & 50w models only) as this will have an impact on the lighting design to ensure the correct light levels are achieved.

**Please Note:** The cable must be connected either through a waterproof connector or junction box. The waterproof connector or junction box is not supplied and will need to be purchased separately.

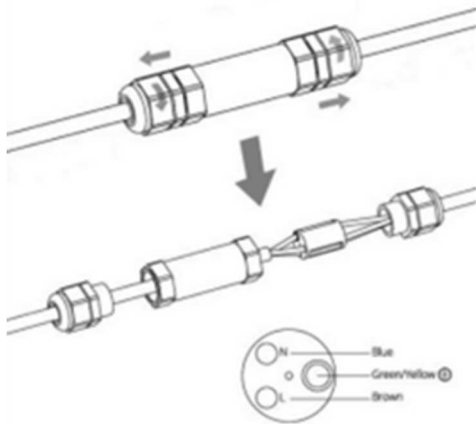

## **Maintenance**

Repairs should only be carried out by a suitably qualified person. Regular cleaning of luminaires should be carried out at regular intervals not only to ensure good optical performance but also ensure that dirt does not accumulate to such an extent as to impair the electrical or thermal safety of the fitting. This should be done with the luminaire switched off/isolated and a soft damp cloth should be used, do not use any chemicals or abrasives.

## **Light Source Maintenance**

The light source of this luminaire is not replaceable; in case the light source needs to be replaced (e.g. at the end of its life), the whole luminaire shall be replaced.

## **Warranty**

This product is covered by an extended warranty for 5 years from date of purchase.

The extended warranty is available for installations in the UK or Ireland by a competent person in accordance with the current building and IEE wiring regulations.

If the defective product is no longer available, then Challenger may provide alternatives of similar specification and quality.

The ambient temperatures and environment and voltage range according to manufacturer specifications are not exceeded

The product is not exposed to any adverse mechanical stresses or impact

For full terms and conditions in regard to our extended warranty please refer to the website.

**LinkedIn**



Follow us for all the latest news and product information

**CHALLENGER SECURITY PRODUCTS**

10 Sandersons Way,  
Blackpool, FY4 4NB

Email: [enquiries@challenger.co.uk](mailto:enquiries@challenger.co.uk)

Web: [www.challenger.co.uk](http://www.challenger.co.uk)

Due to our policy of continuous improvement we reserve the right to change specification without prior notice. Errors and omissions excepted. These instructions have been carefully checked prior to publication. However, no responsibility can be accepted by Challenger for any misinterpretation of these instructions.

