

ECOLINK Floodlight

Ecolink BVP009

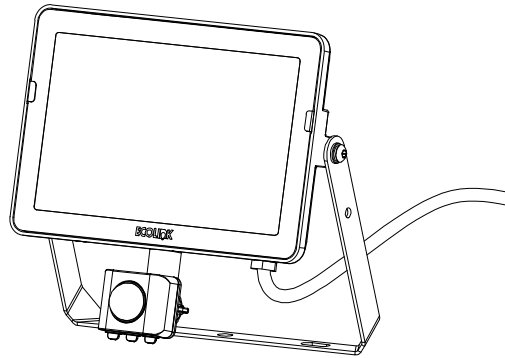

	Flux (lm)	Power (W)	Beam	m ³	kg
Ecolink BVP009 10W 4000K MDU	850	10	100° 120°	0.0012	0.37
Ecolink BVP009 20W 4000K MDU	1700	20		0.0016	0.46
Ecolink BVP009 30W 4000K MDU	2550	30		0.0025	0.6
Ecolink BVP009 50W 4000K MDU	4250	50		0.0034	0.78

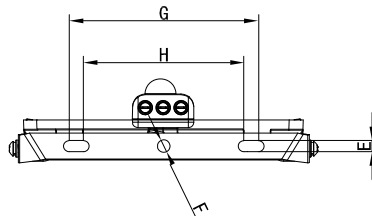
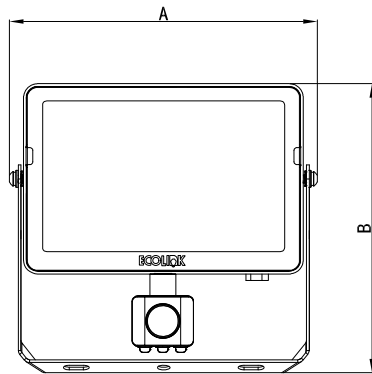
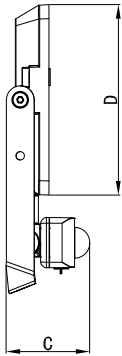

	mm			
	10W	20W	30W	50W
A	107	140	185	223
B	137	153	183	210
C	58	54	56	57
D	62	85	117	136
E	5	5	6	8.5
F	5.5	5.5	6.5	9
G	50	81	106	135
H	40	69	94	115

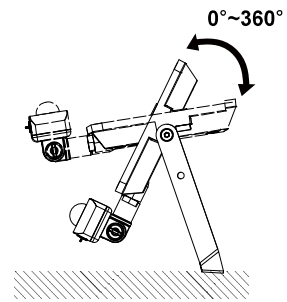

Data subject to change without notice

Install the luminaire according to the national regulations. 3P terminal, the terminal is at least rated voltage

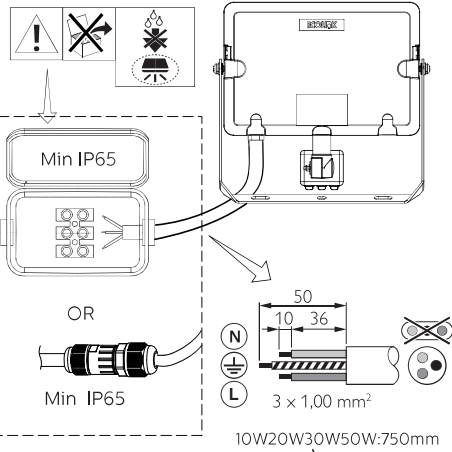

- Always use IP65 or higher IP rated junction box/connector for wiring connection.
- The Luminaire should never be used in submerged wet conditions e.g. under water, soil, snow etc.
- The wiring connection should also never be used in submerged wet conditions e.g. water, soil, snow etc. OR use IP68 junction box.
- The warranty is void, in case any of the instructions / guidelines are not followed as per given mounting instruction.
- This product is not supplied with any junction box / connector.
- For further clarification, please contact the manufacturer.



If the luminaire is higher >3 m, the use of 2nd fixing security system is needed.

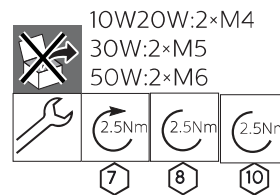
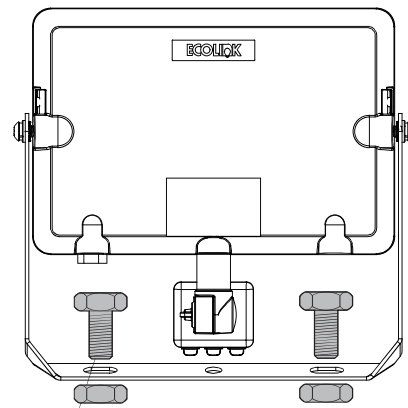

1a

1b

2

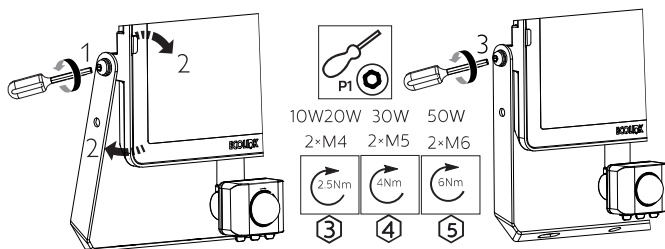

2a

2b

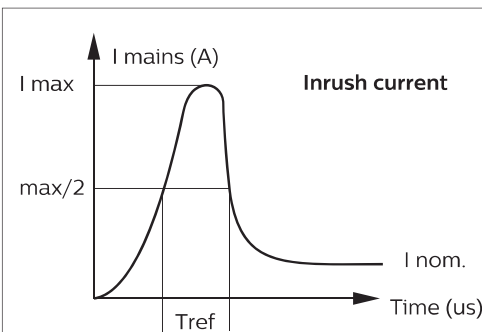
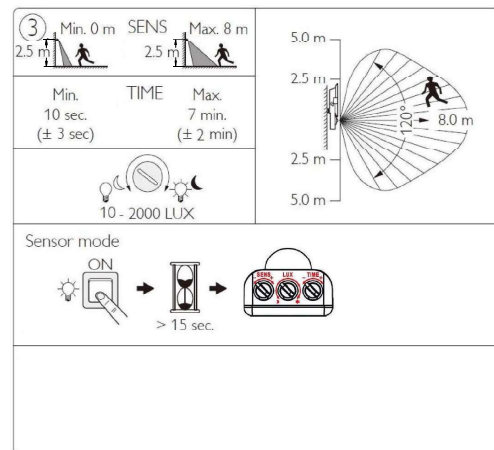

	10W	20W	30W	50W
Electrical characteristics				
I _{max} (A)	0.31	0.45	0.78	1.08
T _{ref} (μs)	56	66	63	58
MCB Floodlight Max.				
B-10 A	136	68	45	27
B-16 A	218	109	73	44
C-10 A	159	80	53	32
C-16 A	256	127	85	51

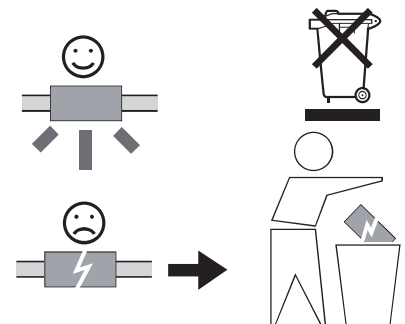

- The luminaire shall be installed or maintained by a qualified electrician and wired in accordance with the latest IEE electrical regulations or the national requirements.
- The external flexible cable or cord of this luminaire cannot be replaced; if the cord is damaged, the luminaire shall be destroyed.
- The light source of this luminaire is not replaceable; when the light source reaches its end of life the whole luminaire shall be replaced.
- Luminaire must not be used or stored in corrosive environment where hazardous materials such as sulphur, chlorine, phthalates, etc. are present.
- To reduce the risk of strangulation the flexible wiring connected to this luminaire shall be effectively fixed to the wall if the wiring is within arm's reach