

# CLASSIC 100



WC & Bathroom Fans



Range of 100mm 230V WC & bathroom fans providing the versatility of wall, panel or ceiling mounted models. Offering a variety of optional features to include adjustable timers, humidity sensors, pullcord and thermo-electric shutters. With airflow rates of approximately 28 l/s, the CLASSIC 100 meets and exceeds the requirements of the Building Regulations.

## Features

- Neon light
- Suitable for wall, panel or ceiling mounted applications
- Standard Thermal Overload Protection (S.T.O.P.) fitted as standard
- IP44 rated
- Double insulated
- Ball bearing motors
- Two year guarantee

## Benefits

- Complies with building regulations
- Versatile, to fit wall, panel or ceiling mounted applications

## Optional Features ▼



### Adjustable Over Run Timer

Operates after a 50 second delay. Thereafter the fan operates automatically. The 'run-on' time is adjustable and can be set to 5, 20 or 30 minutes.



### Thermo-Electric Shutter

Integral thermo-electrically operated shutter.



### Adjustable Humidity Sensor

The level of humidity for the bathroom can be chosen from between 60% and 90% RH. The extract fan will continue to work long enough to reach the selected level.



### Pullcord

Supplied with pullcord override.



All fans are manufactured from injection moulded plastics and are suitable to operate in air temperatures up to 40°C. Fitted with neon light indicator and single phase 230V-50Hz, class B motor, all fans are double insulated and fitted with thermal overload protection as standard.

ORDER CODE	CLAS100S	CLAS100T	CLAS100HP	CLAS100XP	CLAS100XHP	CLAS100XT	CLAS100XHT
Neon Light	•	•	•	•	•	•	•
Ball Bearing Motors	•	•	•	•	•	•	•
Thermo-Electric Shutter				•	•	•	•
Adjustable Over Run Timer		•				•	•
Adjustable Humidity Sensor			•		•		•
Pullcord			•	•	•		

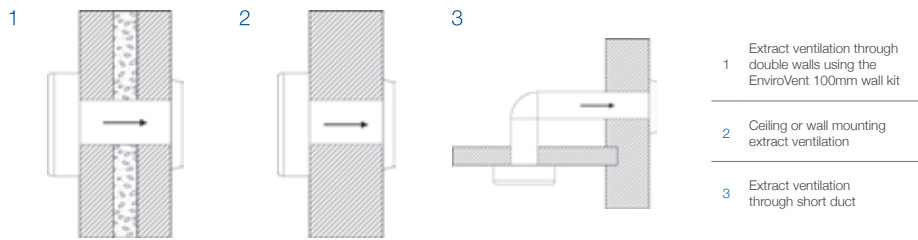
Installation Options ▼Options & Ancillaries ▼

Description	Code(s)
Standard Wall Kit	1RDEFWAK100
Rigid Ducting	1RD100X1M 1RD100X2M 1RD100X3M
Flexible Hose Ducting	1RDFLEX100X3M 1RDFLEX100X6M 1RDFLEX100X15M
Fixed Louvre Grille	1RDGRILL100

Performance Data ▼

MODEL	Speed (r.p.m.)	Watts (W)	Voltage (V)	Airflow l/s (m <sup>3</sup> /h)	dB(A) @ 3m	Weight (Kg)	IP Rating	Ø Duct (mm)
CLASSIC 100 S	2450	15	230	25 (90)	32	0.48	IP44	100
CLASSIC 100 T	2450	15	230	25 (90)	32	0.48	IP44	100
CLASSIC 100 HP	2450	16	230	25 (90)	32	0.48	IP44	100
CLASSIC 100 XP	2450	20	230	25 (90)	32	0.48	IP44	100
CLASSIC 100 XHP	2450	21	230	25 (90)	32	0.48	IP44	100
CLASSIC 100 XT	2450	21	230	25 (90)	32	0.48	IP44	100
CLASSIC 100 XHT	2450	21	230	25 (90)	32	0.48	IP44	100

Related Information ▼

Description	Page Number(s)
Domestic Ancillaries	136-141
Wiring Diagrams	156-157

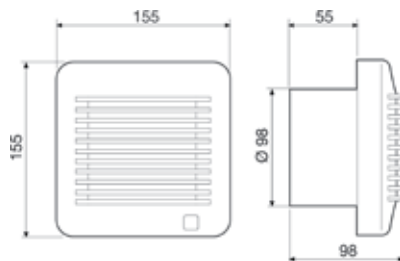
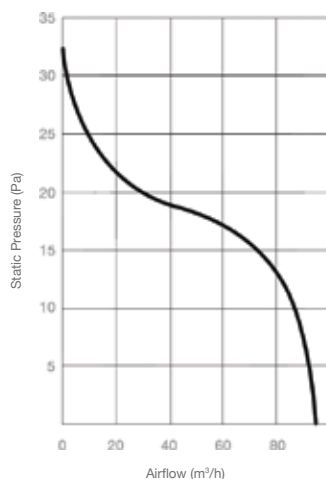
Dimensions (mm) ▼Performance Curve ▼Technical Specification ▼**Product**

The CLASSIC 100 is a versatile domestic axial extract fan designed to solve ventilation problems in small rooms and bathrooms. The fan is double insulated with Standard Thermal Overload Protection (S.T.O.P.).

**Applications**

The CLASSIC 100 can be wall, panel or ceiling mounted to meet The Building Regulations - Part F (England), Scottish Building Regulations Section 3 and Part K (Northern Ireland). The fan will ventilate domestic small rooms and bathrooms.

**Performance**

MODEL	CLASSIC 100
Speed (r.p.m.)	2450
Watts (W)	15-21
Voltage (V) 50Hz	230
Airflow l/s (m <sup>3</sup> /h)	25 (90)
dB(A) @ 3m	32
Weight (Kg)	0.48
IP Rating	IP44
Ø Duct (mm)	100

**Installation**

Full installation guide is enclosed with all products; or sent separately in advance - if required.

**Motor**

Is a 230V 50Hz A/C motor, which is assembled with ball bearings.

**Fan**

The impeller is axial flow type.

**Servicing / Maintenance**

The extract fan should be cleaned periodically by a competent person.

**Guarantee**

The CLASSIC 100 is covered by a 2 year warranty.

**Compliance**

CE