

# ***FASTCATS***

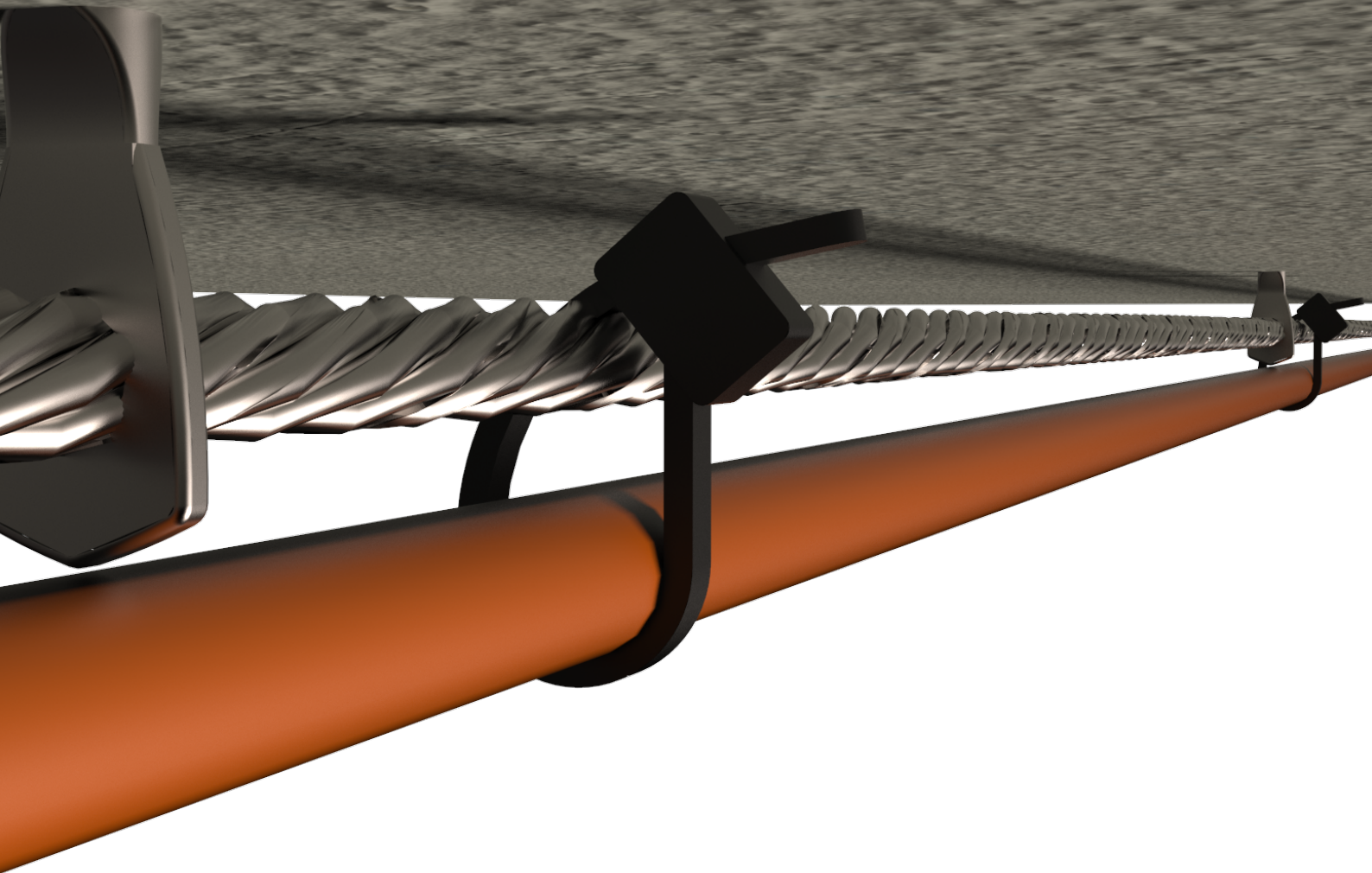

## **2.0MM CATENARY KITS**

For fast installation of cable runs

---

Hi-tensile wire rope spans to quickly and securely run cables efficiently in a visually clean and professional manner.



# What's in the box



Part Code	Wire (m)	FASTCATS locks	Anchors Supports	Drill bit
CAT2-100-10	100	10	-	-
CAT2-250-30	250	30	-	-
CAT2-500-50	500	50	-	-
CAT2-500-100	500	100	-	-
CAT2-100-10-C30	100	10	30	1
CAT2-250-30-C60	250	30	60	1
CAT2-500-50-C100	500	50	100	1
CAT2-500-100-C200	500	100	200	1



Top Up Kits are also available. These include a number of FASTCATS locks, support anchors, and drill bits.

Part Code	Wire (mm)	FASTCATS locks	Anchors Supports	Drill bit
CTU1	-	25	100	1
CTU2	-	50	150	2
CTU3	-	100	200	3

## SPECIFICATION

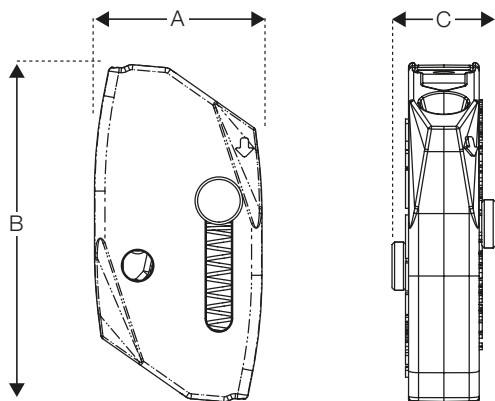

Dimension	No.2 (mm)
A	17
B	34
C	10

## SUBMITTAL INFORMATION

Load Rating for 2.0 mm wire rope:  
Minimum break 225 kg

Material:  
7x7 full steel core.  
Tensile grade 1770

Material:  
Galv wire as standard

Wire Size:  
2.0 mm

Supplied:  
Custom wire lengths and FASTCATS  
hanger quantities as required

Testing:  
Tested to destruction by  
Polyplas International



# 2.0mm Catenary Kits - Load ratings & support spacing

When installing FASTCATS catenary spans it is crucial to install supports at appropriate intervals based on the load (kg/m) and the tension of the wire.

The lower the tension of the wire (i.e the greater the sag between each support), the greater the distance can be between each support and the greater the load per metre. The tables below outline the permissible installation scenarios based on the

weight per metre to be supported, the distance between supports, and the allowable sag. Choose the relevant load table based on your kg/m load requirements and you will see the spacing and sag options available to you.

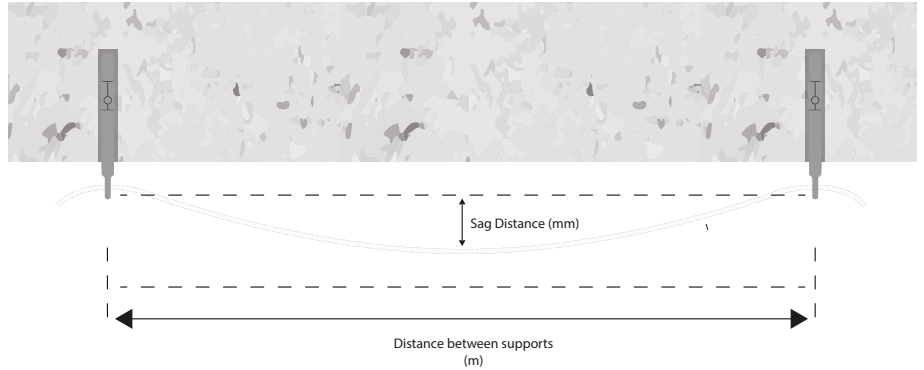

Correct installation for 0.25 kg/m								
0.25 kg/m		Allowable drop between supports (sag - in mm)						
		100	50	20	10	5	2	1
Spacing (m)	1	OK	OK	OK	OK	OK	OK	OK
	2	OK	OK	OK	OK	OK	OK	OK
	3	OK	OK	OK	OK	OK	OK	NOT OK
	4	OK	OK	OK	OK	OK	NOT OK	NOT OK
	5	OK	OK	OK	OK	OK	NOT OK	NOT OK
Correct installation for 0.5 kg/m								
0.5 kg/m		Allowable drop between supports (sag - in mm)						
		100	50	20	10	5	2	1
Spacing (m)	1	OK	OK	OK	OK	OK	OK	OK
	2	OK	OK	OK	OK	OK	OK	NOT OK
	3	OK	OK	OK	OK	OK	NOT OK	NOT OK
	4	OK	OK	OK	OK	OK	NOT OK	NOT OK
	5	OK	OK	OK	OK	NOT OK	NOT OK	NOT OK
Correct installation for 0.75 kg/m								
0.75 kg/m		Allowable drop between supports (sag - in mm)						
		100	50	20	10	5	2	1
Spacing (m)	1	OK	OK	OK	OK	OK	OK	OK
	2	OK	OK	OK	OK	OK	OK	NOT OK
	3	OK	OK	OK	OK	OK	NOT OK	NOT OK
	4	OK	OK	OK	OK	NOT OK	NOT OK	NOT OK
	5	OK	OK	OK	OK	NOT OK	NOT OK	NOT OK
Correct installation for 1.0 kg/m								
1.0 kg/m		Allowable drop between supports (sag - in mm)						
		100	50	20	10	5	2	1
Spacing (m)	1	OK	OK	OK	OK	OK	OK	OK
	2	OK	OK	OK	OK	OK	NOT OK	NOT OK
	3	OK	OK	OK	OK	OK	NOT OK	NOT OK
	4	OK	OK	OK	OK	NOT OK	NOT OK	NOT OK
	5	OK	OK	OK	NOT OK	NOT OK	NOT OK	NOT OK

Correct installation for 1.5 kg/m								
1.5 kg/m		Allowable drop between supports (sag - in mm)						
		100	50	20	10	5	2	1
Spacing (m)	1	OK	OK	OK	OK	OK	OK	OK
	2	OK	OK	OK	OK	OK	NOT OK	NOT OK
	3	OK	OK	OK	OK	NOT OK	NOT OK	NOT OK
	4	OK	OK	OK	NOT OK	NOT OK	NOT OK	NOT OK
	5	OK	OK	OK	NOT OK	NOT OK	NOT OK	NOT OK
Correct installation for 2.0 kg/m								
2.0 kg/m		Allowable drop between supports (sag - in mm)						
		100	50	20	10	5	2	1
Spacing (m)	1	OK	OK	OK	OK	OK	OK	NOT OK
	2	OK	OK	OK	OK	OK	NOT OK	NOT OK
	3	OK	OK	OK	OK	NOT OK	NOT OK	NOT OK
	4	OK	OK	OK	NOT OK	NOT OK	NOT OK	NOT OK
	5	OK	OK	NOT OK	NOT OK	NOT OK	NOT OK	NOT OK
Correct installation for 2.5 kg/m								
2.5 kg/m		Allowable drop between supports (sag - in mm)						
		100	50	20	10	5	2	1
Spacing (m)	1	OK	OK	OK	OK	OK	OK	NOT OK
	2	OK	OK	OK	OK	NOT OK	NOT OK	NOT OK
	3	OK	OK	OK	NOT OK	NOT OK	NOT OK	NOT OK
	4	OK	OK	NOT OK	NOT OK	NOT OK	NOT OK	NOT OK
	5	OK	OK	NOT OK	NOT OK	NOT OK	NOT OK	NOT OK
Correct installation for 3.0 kg/m								
3.0 kg/m		Allowable drop between supports (sag - in mm)						
		100	50	20	10	5	2	1
Spacing (m)	1	OK	OK	OK	OK	OK	OK	NOT OK
	2	OK	OK	OK	OK	NOT OK	NOT OK	NOT OK
	3	OK	OK	OK	NOT OK	NOT OK	NOT OK	NOT OK
	4	OK	OK	NOT OK	NOT OK	NOT OK	NOT OK	NOT OK
	5	OK	OK	NOT OK	NOT OK	NOT OK	NOT OK	NOT OK