

6A 1P+N Bidirectional Type A 6kA 30mA 1 Module B Curve RCBO

Product Ref: **6ARSN6B**

Technical Features:

- Bidirectional
- Compact design allows for easier installation
- Commercial and residential applications such as EV charging units
- Single Pole and Switched Neutral
- Protection device combines the overcurrent function of an MCB with earth fault function of an RCD
- DIN rail mountable
- Complete with 400mm Neutral cable
- Test button and trip indicator

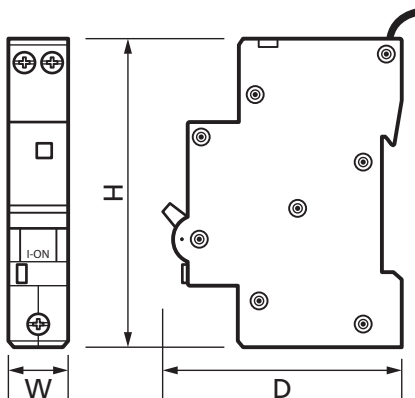

Product Specification

Bidirectional	Yes
Voltage Rating (V)	230V
Current Rating (A)	6A
Weight	0.133kg
Incoming Terminal Capacity	16mm ² (L/N out)
Number of Poles	1P+N (Switched)
Number of Modules	1
Outgoing Terminal Capacity	25mm ² (L in)
Torque Settings (Nm)	1.2Nm (L/N out) / 2Nm (L in)
Short Circuit Rating	6kA
Tripping Characteristics	B Curve
Tripping Sensitivity	30mA
RCD Type	A
Operating Temperature Range	-25 to +40°C
Mounting	Din Rail
Colour	Grey/Blue
Compliance	UKCA, CE
Guarantee	1 Year
Standards	IEC 61009-1
Depth	66mm
Height	87mm
Width	18mm

Errors and omissions excepted (E&OE). All information is subject to change without notice and is correct at the time of print. Refer to issue number and date below.

Tel: +44 (0)1302 342 642 • mcg.co.uk • [✉@mcg_industrial](mailto:info@mcg_industrial)