

# 46610054240VAC

Finder 46 Series Miniature Relay 16A 1 CO 240V AC Coil with PB plus LED plus Mech. Indicator

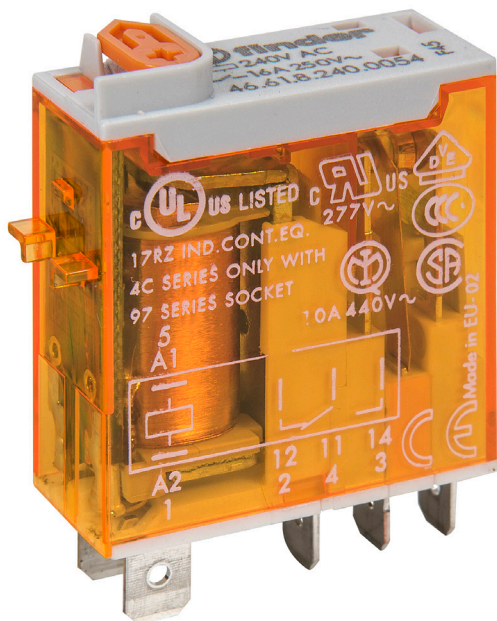

Component type	Switching relay
Range	Panel Mount and Power Relay
Model	N/A
Product status	Existing

The Finder General Purpose Panel Mount and Power Relays are a reliable and efficient switching solution for various applications and industries. Options include coil voltages, output current ratings, contact configurations. A modular design allows for surge suppressors, coil indication and timers. Features manual override, push-to-test, slots for markers, jumpers and gold plated contacts.

## ELECTRICAL

Nominal current	16 A
Nominal voltage AC	250 V
Max. rated operation voltage Ue AC	440 V
Number of contacts as change-over contact	1
Drive, switching attitude	Mono stable
Rated switching power at AC-1	4000 VA
Rated switching power at AC-15, 230V	750 VA
Breaking capacity at DC-1, 30V	12 A
Breaking capacity at DC-1, 110V	0.5 A
Voltage type for actuating	DC
Control supply voltage Us at AC 50HZ	240 V
Control supply voltage Us at AC 60HZ	240 V
With LED indication	Yes
Type of electric connection	Plug-in connection
Electrical life at Un, In (service cycles)	100000 cycles
Drive, polarization	Polarity free
Type of switch contact	Single contact
Material of contact insert	Thermoplastic
Operating voltage	192-264 V

## CONSTRUCTION

Material contact	Silver nickel
With mechanical indicator	Yes
With latching test button	Yes
Suitable for plug-in socket mounting	Yes

## MECHANICAL

Mechanical life (service cycles)	1.0E7 cycles
Max. shock acceleration	20 g
Max. shock duration	4 ms

# 46610054240VAC

Finder 46 Series Miniature Relay 16A 1 CO 240V AC Coil with PB plus LED plus Mech. Indicator



<b>MECHANICAL</b>	Max. vibration acceleration	20 m/s <sup>2</sup>
	Max. vibration frequency, operational	150 Hz
<b>DIMENSIONS</b>	Width	12.4 mm
	Height	29 mm
	Depth	32.8 mm
<b>ENVIRONMENT</b>	Operating temperature	-40...70 °C

## DIMENSIONAL DIAGRAM

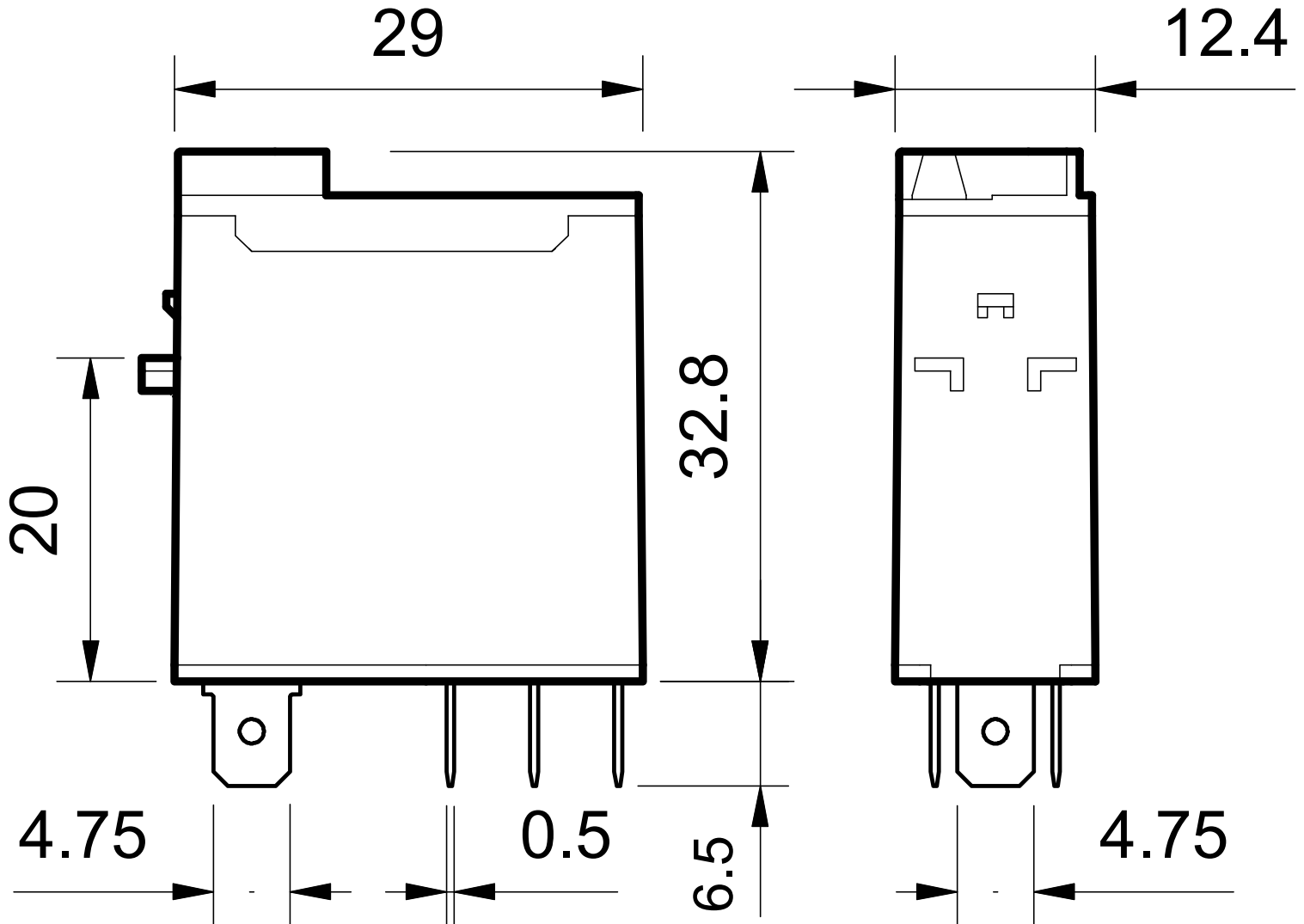

## RELATED PRODUCTS

### ACCESSORY



Item No: 8630240VAC

Required: No

Description: Finder 86 Series Bifunction Timer Module 240V AC



Item No: 863024VACDC

Required: No

Description: Finder 86 Series Bifunction Timer Module 12 to 24V AC DC

# 46610054240VAC

Finder 46 Series Miniature Relay 16A 1 CO 240V AC Coil with PB plus LED plus Mech. Indicator



## RELATED PRODUCTS

### ACCESSORY



**Item No:** 95004

**Required:** No

**Description:** Finder 90 Series ID Tag 9503 and 9505 Bases



**Item No:** 9518

**Required:** No

**Description:** Finder 90 Series Jumper Link for 9505 and 9701 9702 Base 8 Way



**Item No:** 99020024

**Required:** No

**Description:** Finder 99 Series Green LED Module 6 to 24V AC DC



**Item No:** 9902002498

**Required:** No

**Description:** Finder 99 Series Green LED plus Varistor Module 6 24V AC DC



**Item No:** 99020060

**Required:** No

**Description:** Finder 99 Series Green LED Module 28 to 60V AC DC



**Item No:** 9902023009

**Required:** No

**Description:** Finder 99 Series RC Module Plug In 110 to 240V AC DC



**Item No:** 9902023098

**Required:** No

**Description:** Finder 99 Series Green LED plus Varistor Module 110 to 240V AC DC



**Item No:** 99020240

**Required:** No

**Description:** Finder 99 Series Green LED Module 110 to 240V AC DC



**Item No:** 99023000

**Required:** No

**Description:** Finder 99 Series Diode Module Standard Polarity 6 to 220V DC



**Item No:** 99029024

**Required:** No

**Description:** Finder 99 Series Green LED plus Diode Module Standard Polarity 6 to 24V DC



**Item No:** 99029060

**Required:** No

**Description:** Finder 99 Series Green LED plus Diode Module Standard Polarity 28 to 60V DC



**Item No:** 99029220

**Required:** No

**Description:** Finder 99 Series Green LED plus Diode Module Standard Polarity 110 to 220V DC