



INSTRUCTION MANUAL

EW0018

STEAM **DYNAMO**+ Multi Tool Sanitising Steam Cleaner

Ewbank has a British heritage to be proud of. It's a household favourite and much loved brand that has been providing innovative cleaning solutions for over 140 years.



Safety Instructions..... 3 - 4
Appliance Overview5
Operating Instructions..... 6 - 9
Cleaning & Maintenance10
Troubleshooting10
Specifications11
Fuse Replacement.....11
Disposal of the Appliance11
Warranty Terms & Conditions12

SAVE THESE INSTRUCTIONS

Household use only.

PLEASE READ ALL THE INSTRUCTIONS BEFORE USE AND WHEN USING THE APPLIANCE, THE FOLLOWING PRECAUTIONS MUST BE TAKEN:

- The cable is in perfect condition
- All packaging materials are removed from the product
- Do not direct steam at people, animals or at electrical devices
- Do not operate machine without water in the tank
- Do not allow machine to run unattended at any time
- Close supervision is necessary when this machine is used near children. Do not allow it to be used as a toy
- The machine is designed for household use only, do not expose to rain
- Do not overfill the water tank. The machine contains a maximum of 1500ml of water only. Excessive filling of the water tank may cause damage or injury
- Never turn the machine over or tilt when it is switched on or if it's still producing steam
- Use extra care when cleaning on stairs or step-ladders
- To provide continued protection against the risk of electric shock connect properly grounded outlets only
- Use only genuine manufacturer's parts.
- It is recommended that a RCD (residual current device) rated at 30mA is fitted into the mains supply socket for added protection against electric shock
- Do not immerse cord, plug or machine in water or any other liquid

- Do not drag or try to move boiler by pulling either the hose or the mains lead
- Do not operate with a damaged cord, keep feet and all parts of body away from the jet of steam. Do not operate machine in bare feet or when wearing open toe shoes or sandals
- Do not pull or carry by cord, or use cord as a handle, close door on cord or pull cord around sharp edges or corners. Keep cord away from heated surfaces
- Unplug cleaner when not in use. Turn all controls off before unplugging from electrical outlet
- Do not unplug by pulling on cord. Always grasp the plug, not the cord. Never handle plug or appliance with wet hands
- Store in a dry place. Do not expose machine to freezing temperatures
- This appliance is not intended for use by persons (including children) with reduced physical, sensory or mental capabilities, or lack of experience and knowledge, unless they have been given supervision or instruction concerning use of the appliance by a person responsible for their safety
- The boiler becomes hot in use. Move only by using the carrying handle
- Allow to cool completely before emptying boiler
- Do not stand on boiler or hose
- The equipment must be unplugged after use and before cleaning



PACK CONTENTS

- | | |
|-------------------------|-----------------------------------|
| 1. Steam Dynamo+ | 9. Window/Tile Cleaner |
| 2. Jug | 10. Jet Nozzle |
| 3. Funnel | 11. BBQ Brush |
| 4. Towel | 12. Wall Paper Steamer |
| 5. Straight Adaptor | 13. Plastic Brushes Large & Small |
| 6. Steam Cap | 14. Turbo Brush |
| 7. Extension Wands | 15. On/Off Button |
| 8. Floor Tool & Adaptor | 16. Steam Gun |

Please note that some accessories are secured in a recyclable plastic bag accessed by lifting the smoked coloured panel at the front of the unit.

FITTING THE ACCESSORIES

- The accessories may be fitted to the steam gun (16) using adaptor (5)
- When fitting the squeegee, adaptor (5) is required
- When using the round brushes or high-pressure nozzle, adaptor (5) is required.

WARNING - Risk of injury

CAUTION! Steam 100° C - Don't direct at people or animals

Cleaning Fabrics

A number of materials and fabrics are NOT suitable to be cleaned by steam for example: Do not use on leather, wax polished furniture or floors, synthetic fabrics, velvet, Dralon® or other delicate, steam-sensitive materials. All carpets and fabrics should be tested first before use.

Cleaning Glass/Mirrors:

Thermal shock can shatter glass. Before cleaning glass surfaces, carefully warm the surface by directing the steam jet on the glass from a distance of no less than 6" or 15cm.

How to put your Steam Dynamo+ together

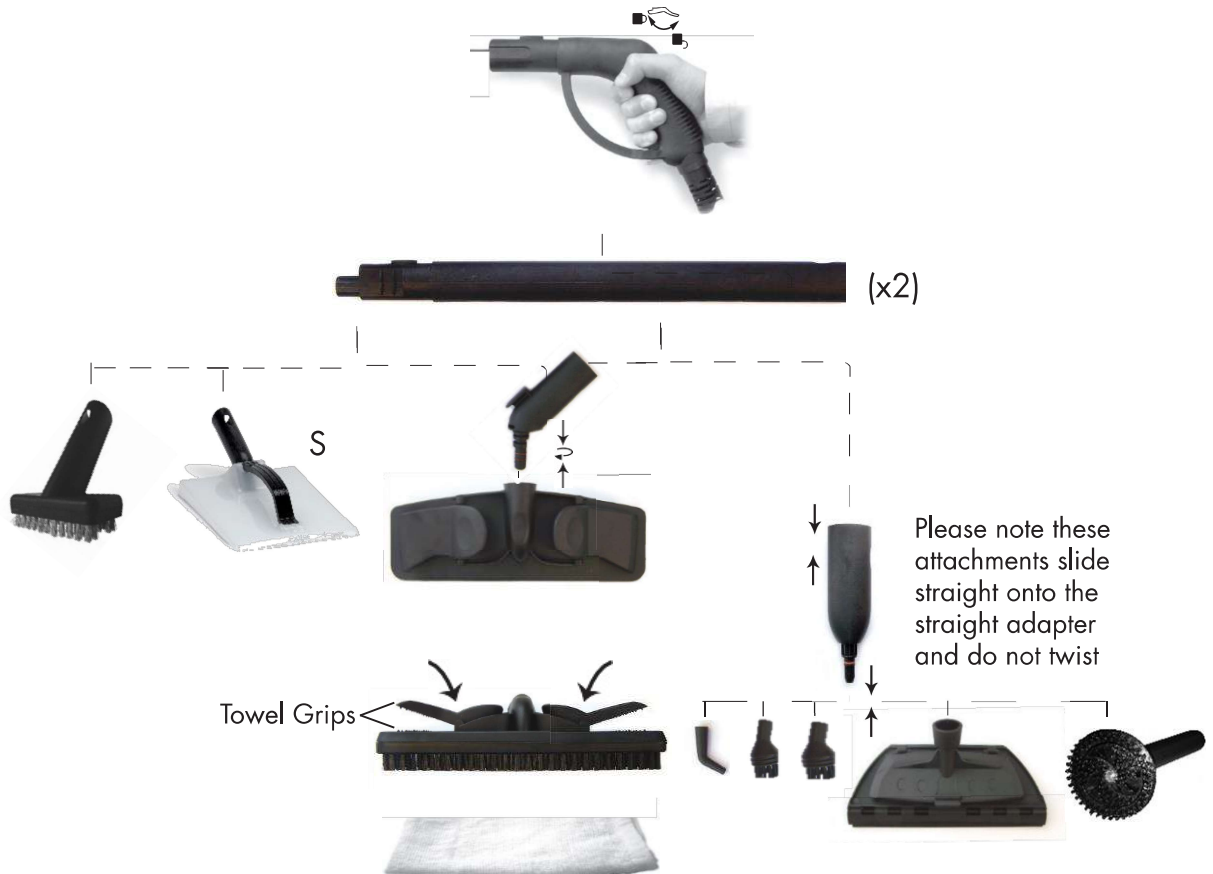

NOTE: The number references in the following section relate to the Appliance Overview image on page 5

CLEANING FLOORS

- Make sure the machine is unplugged from the electrical outlet.
- Unscrew the steam cap (6) by turning anti-clockwise.

Please note the cap cannot be unscrewed when the unit is pressurized.

- Using the measuring jug and funnel (2 & 3) fill the machine with up to 1500ml of water. This should be sufficient to steam clean for approximately 35 minutes
- Once full, replace the safety cap (6) by turning clockwise and fasten tightly
- Attach the accessory or floor cleaning tool you require to the machine (see page 6)
- Now plug the machine into the electrical outlet and switch on. Two lights should illuminate. The red light is a power indicator. The orange light indicates that the machine is building steam pressure
- When the machine is first turned on this light will illuminate. The machine takes up to 12 minutes to reach the correct pressure level depending on the amount & temperature of water
- Once the orange light has gone out the machine is ready to use. The orange light may come back on when the machine is in use. If this happens, release the safety trigger and allow the steam pressure to build up once again. This should take no longer than 40 seconds. If the safety trigger is pressed when the orange light is on, hot water may come out of the machine

REFILLING THE WATER TANK

- Switch the machine off using the on/off button (15)
- Disconnect the power cable from the electrical outlet. Wait 5 minutes before squeezing the safety trigger to make sure the machine is no longer under pressure before unscrewing the safety cap. DO NOT unscrew the safety cap until the steam has stopped
- Fill the water tank as necessary using the funnel provided. DO NOT exceed 1500ml of water before replacing the safety cap by turning clockwise. Fasten cap tightly
- You are now ready to switch the machine on and resume steam cleaning

HOW TO USE THE HANDLE

- Press the button at the end of the nozzle in to attach the straight adaptor or the extension tubes
- Squeeze the trigger on the handle for steam
- Lock the trigger for constant steam

HOW TO USE THE TOOLS

- The jet nozzle and the brush tool can be used to get into awkward corners that are normally difficult to clean
- Use the brush tool to scrub and loosen stubborn dirt from hard surfaces
- Use the window/tile cleaner to clean grime from tiles and windows
- To use these tools, first fit the straight adaptor. Depress the button on top of the handle and push the straight adaptor on
- Now you can push any of these three tools onto the tip of the straight adaptor. Please note that these attachments slide onto the straight adaptor (do not twist)
- Attach the floor brush to the extension wands, which snap together. Then attach the extension wand to the steam gun. Do ensure the extension wands are firmly connected
- Before cleaning always remove dust from the surface you wish to clean
- To release the extension wands depress the button on the hose connection

CLEANING WITH CLEANING CLOTH

- While the machine is switched off attach the cleaning cloth to the floor brush via the spring-loaded clips, Make sure the edges of the cleaning cloth are secure
- DO NOT attempt to do this while the machine is still hot
- Never remove the cleaning cloth while the safety trigger is released or the machine is warm to the touch

HOW TO USE THE WALLPAPER STEAMER

1. Your wallpaper steamer may be supplied with the handle separate to the plate and requiring assembly - this requires the handle to be locked into place on the steam plate and then secured with the two screws provided
NOTE: Do not use without correctly attaching the handle
2. Now attach the fully assembled wallpaper steamer to the steam control gun
3. Before using, direct the wallpaper steamer into a bucket and press the trigger to remove any condensation build up in the steam hose
4. It is highly recommended that you test a small area of the wall before full commencement of the operation; this is to check that you do not have any loose plaster, as the pressurised steam could get behind and "blow" the plaster away from the wall
5. Faster removal of wallpaper can be achieved by scoring the wallpaper before steaming - a crisscross pattern scored into the wallpaper to be stripped achieves the best results
6. Place the wallpaper steamer directly against the wallpaper for around 12 seconds, and then move on to the area next to where you have just been steaming - you should now be able to easily remove the wallpaper from the previously steamed area with a wallpaper scraper
7. Continue working in this fashion until all the undesired wallpaper is removed; steaming and scraping at the same time - working in a "Z" pattern is found to be most effective, starting at the top of the wall

8. Some types of wallpaper may require longer steaming times especially painted papers or anaglypta
9. Always take care when using the wallpaper steamer and ensure that it is never directed towards people or pets

NOTE: Never use the wallpaper steamer immediately over any electrical socket or switch in case of electric shock

HOW TO USE THE BBQ BRUSH

- The BBQ brush fits onto the steam gun in the same way as the other accessories and is used to clean various enamel type surfaces
- With stainless steel bristles this is a more aggressive type of cleaning tool, so care needs to be taken on any surface which could be damaged

NOTE: If you have used chemical cleaners on the surface to be cleaned, it must be washed off entirely before using the BBQ brush

WARNING - Risk of injury!

- Cleaning and maintenance operations should be carried out with the appliance disconnected from the power supply
- The machine should be allowed to completely cool down before it is stored away or cleaned
- Clean the machine and its accessories with a slightly damp cloth only.
- Never use a cleaning product or detergent
- To ensure that your machine operates correctly over a long period, rinse out the water tank once a month to remove lime-scale deposits. A vinegar solution or a descale solution can be used to clean inside the water tank
- There are no customer service parts to the boiler unit, all repairs must be carried out by a qualified person

TROUBLESHOOTING

If you experience difficulties with the appliance, please check the suggestions below before contacting customer services on 01473 271272:

PROBLEM	POSSIBLE SOLUTION
Water comes out of the Nozzle	The Steam Cleaner creates a large amount of steam. This may condense as water or water droplets in the Steam Hose and can be expelled when used after a period of cooling. This is normal and not a cause for concern.
No Steam comes out	Check that the hose has not become kinked or blocked- Also check the power supply and water level.
I can't get the Pressure Cap off	Make sure that you have fully de-pressurized the Boiler. See the section refilling the water tank.
Steam flow is erratic; sometimes it works well, other times it does not	If you have not used distilled or deionized water, you may have a small blockage inside your Steam Cleaner. Try descaling your unit. Check all attachments are fitted correctly.
I live in a hard water area, my Steam Cleaner does not work as well	Empty the machine after use. In hard water areas your Steam Cleaner may benefit from occasional descaling. This can be done by using a kettle descale solution. You can also use distilled or deionized water to extend the life of the product.

Model:	EW0018 STEAM DYNAMO+
Cord Length:	2.5m
Water Capacity:	1500ml
Steam-Up Time:	up to 12 mins depending on volume & temperature of water
Working time:	35 mins
Tank Material:	Stainless Steel
Power	2000W

Fuse Replacement (Class I)

Remove the fuse cover with a small flat head screw driver. Take out the fuse and replace with a new fuse of the same Amp. Replace the fuse cover and push back into place.



Disposal Information

The European Directive 2012/19/EU on Waste Electrical and Electronic Equipment (WEEE), requires that old household electrical appliances must not be disposed of in normal unsorted municipal waste.

Old appliances must be collected separately in order to optimise the recovery and recycling of the materials they contain and reduce the impact on human health and the environment.

The crossed out "wheeled bin" symbol on the product reminds you of your obligation, that when you dispose of the appliance it must be separately collected. Consumers should contact their local authority or retailer for information concerning the correct disposal of their old appliance.





Ewbank Warranty Terms & Conditions

This product is guaranteed for a period of 24 months as standard from the date of purchase against mechanical and electrical defects.

To qualify for the warranty, the product must be used for domestic household use only and in accordance with the instructions in the user manual. Any misuse of the product will result in the warranty being void.

The warranty does not cover accidental damage, misuse, neglect, tampering or incorrect adjustment or installation.

The warranty will be rendered invalid if the product is resold, has had its serial number removed (or has an invalid serial number), or if an unauthorised person has carried out any repairs or alterations.

The warranty does not cover accessories or consumable parts that require replacement under normal use. This includes shelving, dials, filters, belts and trays etc.

In the unlikely event of a breakdown please refer to the Troubleshooting guide in your user manual and check all plugs, fuses and the electricity supply.

If you still require assistance please contact our Customer Service department on **01473 271 272** or write to us at the following address:

**Customer Service Department
Ewbank, 38 Bluestem Road,
Ipswich, Suffolk, IP3 9RR**

Please quote the Product Code and the PO Number on the rating label and give details of the exact fault. We will then decide whether to repair or replace the item.

Before we arrange the repair or replacement you will be required to return a copy of your proof of purchase. Please retain your original.

If an item is replaced within the agreed warranty period, the warranty for the replacement item will be calculated from the purchase date of the original.

In the event that the product is inspected and no fault is found or the product is not within the warranty period you will be charged for the repair and any carriage costs.



Your Guarantee

This product is covered by a 2 year guarantee.
This does not cover normal wear and tear or abuse.
For guarantee purposes, please retain your original receipt as proof of purchase.
This guarantee does not affect your statutory rights.
For spares, service and further information please contact;
Ewbank, 38 Bluestem Road, Ipswich, Suffolk, IP3 9RR
EU: Castle Electrical Factors Ltd., Dundalk, A91 KA9R, IR
Tel: 01473 271 272

Disclaimer: Ewbank operate a policy of continual improvement and development.
We therefore reserve the right to change/alter the specification and appearance of our appliances without prior notice.
All diagrams and images shown in this manual are for illustration purposes only.