

| Product Code  | Product Range   | Issue No. | Issue Date | Issue By |
|---------------|-----------------|-----------|------------|----------|
| <b>200BC2</b> | Busbar chambers | B         | April 2026 | T.T.     |

### Description

4 pole horizontal busbar chamber.  
Steel enclosure.

### Features

High fault level.  
Modern design to latest standards.  
Robust, industrial style chamber for more cabling space.



### General Characteristics

|                               |                                                                                                                                             |
|-------------------------------|---------------------------------------------------------------------------------------------------------------------------------------------|
| Standards                     | BSEN61439-1.                                                                                                                                |
| Current Rating                | 200A                                                                                                                                        |
| Voltage Rating                | 400V                                                                                                                                        |
| Fault Current Rating          | 36kA Icc. Remote MCCB or BS88 fuse protection                                                                                               |
| Dielectric strength           | 2000V ac                                                                                                                                    |
| IP Rating                     | 3X                                                                                                                                          |
| Pollution Degree              | 3                                                                                                                                           |
| No. of Poles                  | 4                                                                                                                                           |
| Connection bolts supplied     | 1x M8 bolt for each pole                                                                                                                    |
| Terminal Torque – M8          | 20Nm (BLC8/23)                                                                                                                              |
| Insulation Voltage (Ui)       | 690V                                                                                                                                        |
| Rated frequency               | 50 / 60Hz                                                                                                                                   |
| Equipment Type                | Fixed                                                                                                                                       |
| Approx. Weight kg             | 13.5                                                                                                                                        |
| Enclosure                     | 1.6mm mild steel.<br>Screw on end plates.<br>Plain top, bottom and sides. Drill to suit site requirements. Bolt on front cover, Pozi screw. |
| Finish                        | RAL 7035. Powder coated, electrostatically applied.                                                                                         |
| Ambient operating temperature | -5 to 40 °C. Not exceeding average of 35 °C in any 24 hour period.                                                                          |
| Maximum altitude              | 2000m                                                                                                                                       |
| EMC environment               | Type A                                                                                                                                      |

|              |               |           |            |          |
|--------------|---------------|-----------|------------|----------|
| Product Code | Product Range | Issue No. | Issue Date | Issue By |
| 200BC2       | Range         | B         | April 2026 | T.T.     |

**Dimensions.**

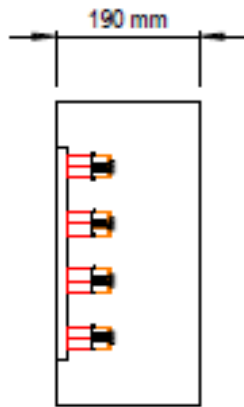
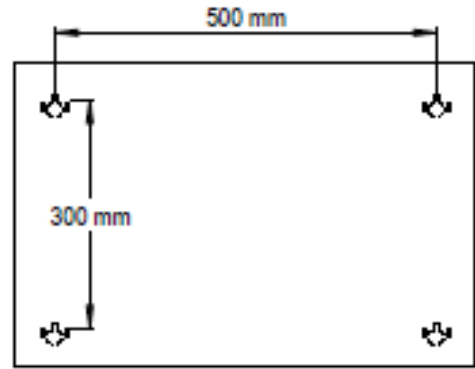
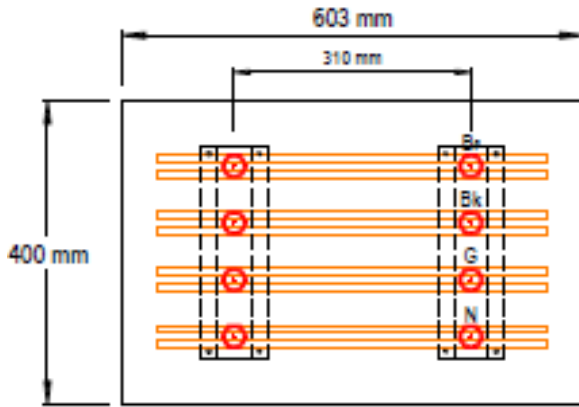

4 x Connection bolts supplied



BLC8/23.

Connection bolt – Place copper washer against busbar face. Place lug on top of copper washer.

**Additional information**

|              |                                                                                                                                                                                                                      |
|--------------|----------------------------------------------------------------------------------------------------------------------------------------------------------------------------------------------------------------------|
| Usage        | Intended for use by skilled persons or instructed persons.                                                                                                                                                           |
| Electrical   | EMC environment: Environment type A.                                                                                                                                                                                 |
| Installation | Service conditions: Wiring of this product must comply with current IEE regulations. Units are intended for indoor use, dry conditions and <b>NOT</b> where high levels of humidity and temperature are experienced. |