

# Product Data Sheet



|               |           |             |           |
|---------------|-----------|-------------|-----------|
| Product Code: | Issue No. | Issue Date: | Issue by: |
| <b>BX12S2</b> | <b>B</b>  | 03/07/2017  | T. Tombs  |

## Description

12 Way TP mcb distribution board with 200A TP switch disconnecter incomer. Max. mcb – 63A.

## General Characteristics

|                                     |  |
|-------------------------------------|--|
| Standards.                          | BS EN 61439-1&3  |
| Current rating.                     | 200A – AC21, 160A - AC22.  |
| Voltage rating.                     | 400V a.c.  |
| Fault current rating.               | 10kA Icc.  |
| Enclosure.                          | 1.2mm cold rolled steel with an epoxy paint finish to RAL7035 matt grey. |
| # Spreader box.                     | Cable spreader box recommended – BXSB1 (265mm high).                     |
| IP Rating.                          | IP 3X  |
| Pollution degree.                   | 3  |
| No of poles.                        | 3 + neutral  |
| # Incomer terminal capacity.        | 70mm.sq. tunnel terminal, 95mm.sq. with links provided – M8 bolt         |
| Incomer terminal tightening torque. | 6 Nm (tunnel 5mm allen key). 20Nm (M8 bolt).                             |
| Cable entry facility.               | Top & bottom endplates removable for ease of cutting.                    |
| Covers / Door.                      | Side hinged solid door (removable) c/w metal turn catch.                 |
| No of Outgoing TP ways.             | 12   |
| Equipment type.                     | Fixed stationary   |
| Weight.                             | 14.25 kg   |



BXSB1 cable spreader box.



## Switchgear Fitted

| Device                     | Rating |
|----------------------------|--------|
| 3 pole switch disconnecter | 200A   |

## General Device Specification – Outgoing Switchgear ordered separately

|              |   |
|--------------|---|
| <b>MCB:</b>  | Please refer to Device data sheet for further information.<br>6 to 63A SP, DP and TP mcb's, type's B, C & D. 6A to 45A single module RCBO's, types B & C. Compact RCBO's, types B & C.<br>Isolator and mcb dolly locks available. |
| <b>Door:</b> | Clear door option available – add /CD to end of part number i.e. BX...S2/CD   |

# Product Data Sheet



|               |           |             |           |
|---------------|-----------|-------------|-----------|
| Product Code: | Issue No. | Issue Date: | Issue by: |
| <b>BX12S2</b> | <b>B</b>  | 03/07/2017  | T. Tombs  |

## Description

12 Way TP mcb distribution board with 200A TP switch disconnecting incomer.

## Key Dimensions

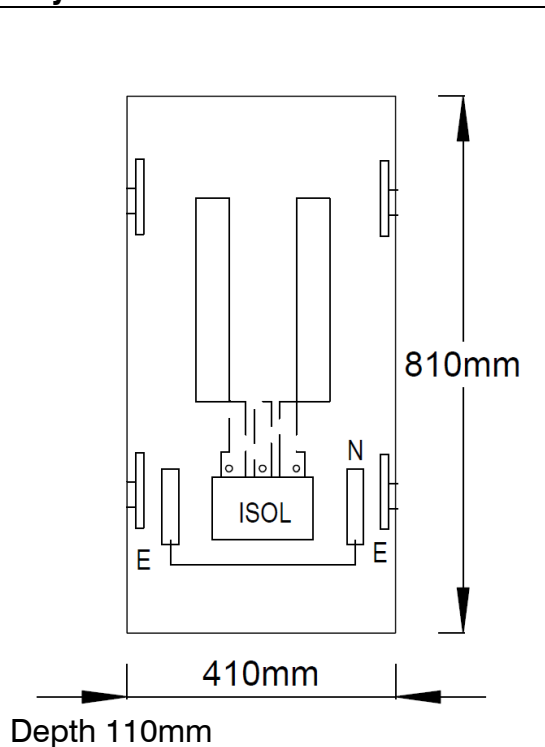

## Mounting hole positions

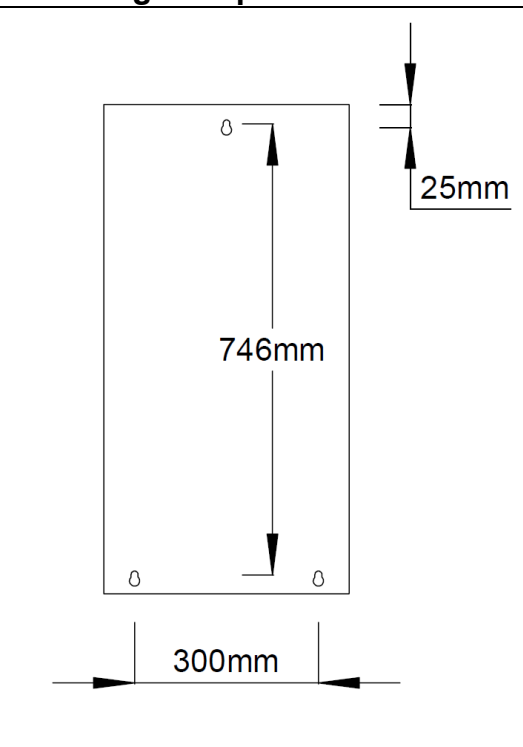

## Fixing foot detail.

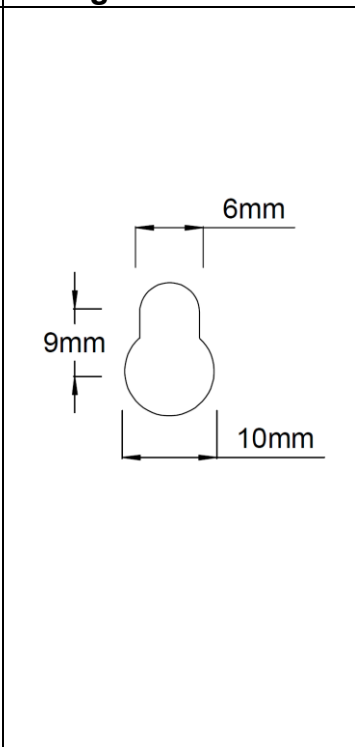

## Additional information.

### Usage

Intended for use by ordinary persons or instructed persons.

### Electrical

Earth & Neutral terminals M10 main bolt, 30Nm. Outgoing terminals: 8 x 25mm.sq, others 16mm.sq. Earth & neutral bar both sides of case.  
Rated frequency: 50Hz.

Rated operational voltage: 230/400V a.c.

Rated insulation voltage: 690V a.c.

Earthing system: Suitable for use with TN-S, TN-C-S and TT systems.

EMC environment: Environment type A.

### Physical

Ambient operating temperature -5 to 40 °C

(Not exceeding average of 35 °C in any 24 hour period).

Maximum altitude 2000m.

Enclosure: Folded mild steel enclosed assembly. Powder coated in Hard wearing epoxy matt light grey paint to RAL 7035.

### Installation

Service conditions: Wiring of this product must comply with current IEE regulations. Units are intended for indoor use and dry conditions and **NOT** where high levels of humidity and temperature are experienced.

Note: IP rating of enclosures can be compromised if correct use of glands is not followed when installing unit.