

PLEASE ENSURE YOU HAVE READ
AND FULLY UNDERSTOOD THIS
GUIDE BEFORE INSTALLATION!

Thermomirror PRO

Installation Guide

YOUR STEP-BY-STEP GUIDE TO
THE PERFECT INSTALLATION



thermomirror
MIRROR DE-STEAMING

Installation: Thermomirror PRO

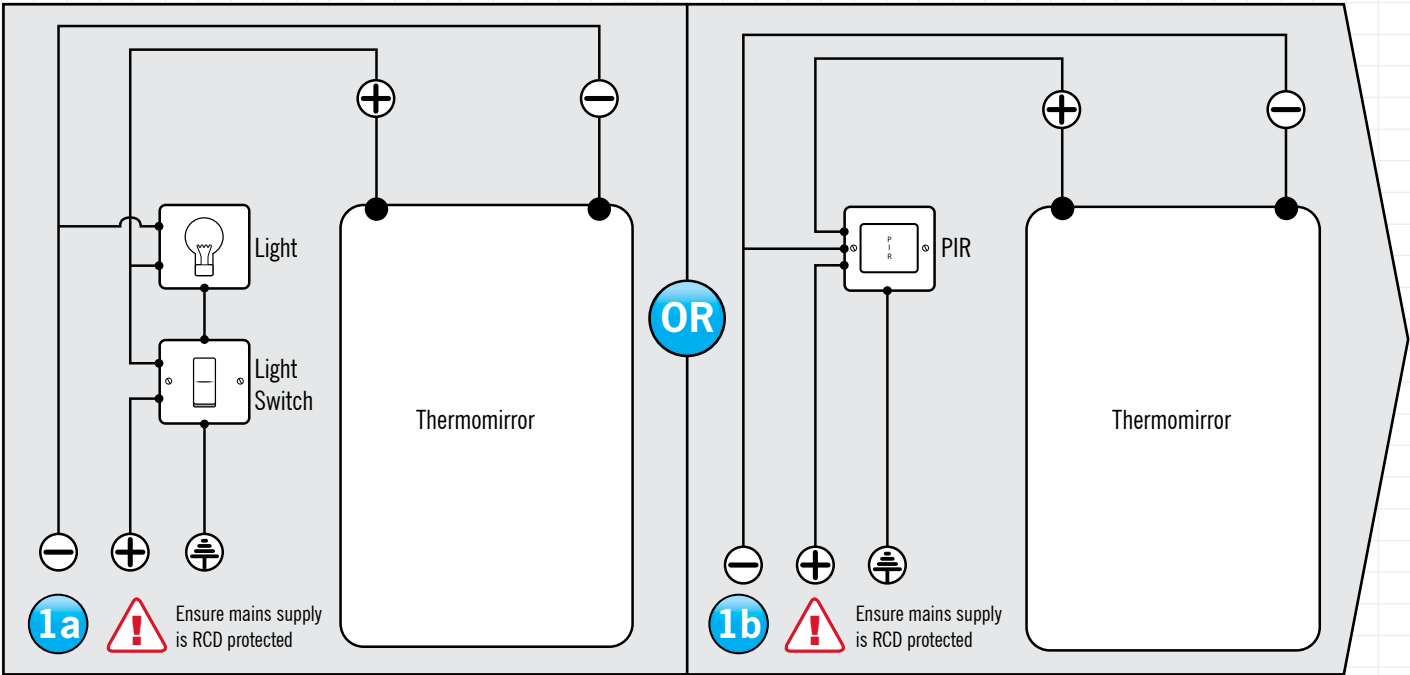

Step 1a & 1b: Plan your installation & layout

Thermomirror should be connected to the lighting circuit so that it is activated by a light switch or PIR movement sensor.

Mark the outline of your mirror on the wall and mark the position of Thermomirror. Check mirror fixing positions and mark these on the wall ensuring that they do not conflict with the heater or connection wires.

When planning your installation, allow for a 5mm expansion gap around the perimeter of the mirror. Any contact with hard materials could result in a breakage (see below). This gap should be filled with a sanitary grade silicone sealant.

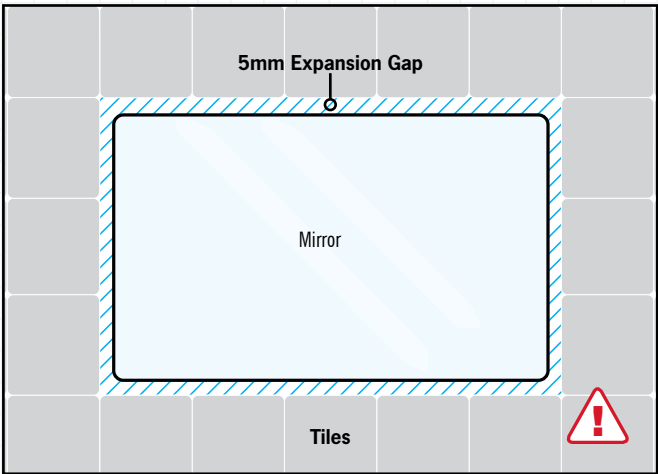

Step 2: Insulate your Thermomirror

Thermomirror emits heat and it is important to provide adequate thermal insulation to avoid heat loss, especially when installing into a cavity wall. Install insulation, we recommend Econoboard (6106), behind Thermomirror to achieve optimal performance and maximise efficiency.

PRO TIP

The heated mirror can be installed on walls made of wood, ceramic tiles, marble, etc. Walls must be dry, stable and preferably insulated.

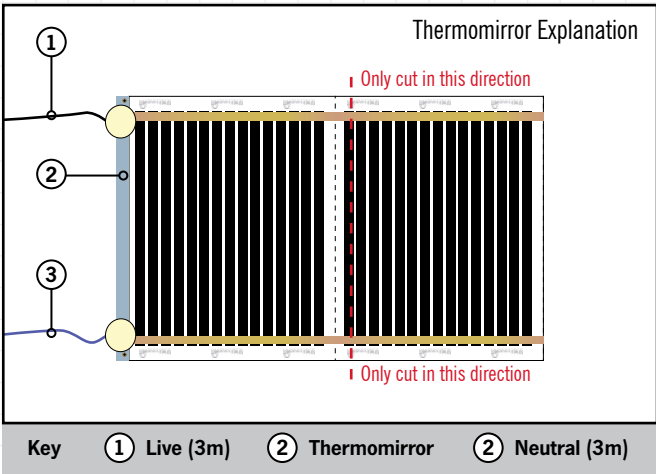

Step 1 & 2 checklist:

- ☐ PLAN AND MEASURE THE INSTALLATION
- ☐ ENSURE WALL IS FLAT AND SMOOTH AND MIRROR IS SUITABLE FOR USE WITH A HEATING SYSTEM
- ☐ CHASE A GROOVE TO ACCOMMODATE WIRES
- ☐ LEAVE EXPANSION GAP AROUND THE PERIMETER OF THE MIRROR

! IMPORTANT SAFETY PRECAUTIONS !

- ALL ELECTRICAL WORK MUST CONFORM TO CURRENT IEE WIRING REGULATIONS AND BE CHECKED OR CARRIED OUT BY A QUALIFIED ELECTRICIAN**
- PLEASE ALLOW A 5MM EXPANSION GAP AROUND THE PERIMETER OF THE MIRROR. FAILURE TO DO SO COULD RESULT IN CRACKS FORMING DUE TO EXPANSION**
- DO NOT PUNCTURE, USE STAPLES OR NAILS TO MOUNT THE HEATING ELEMENT. THERMOMIRROR SHOULD NEVER BE USED IF DAMAGED IN THIS WAY**



Installation: Thermomirror PRO

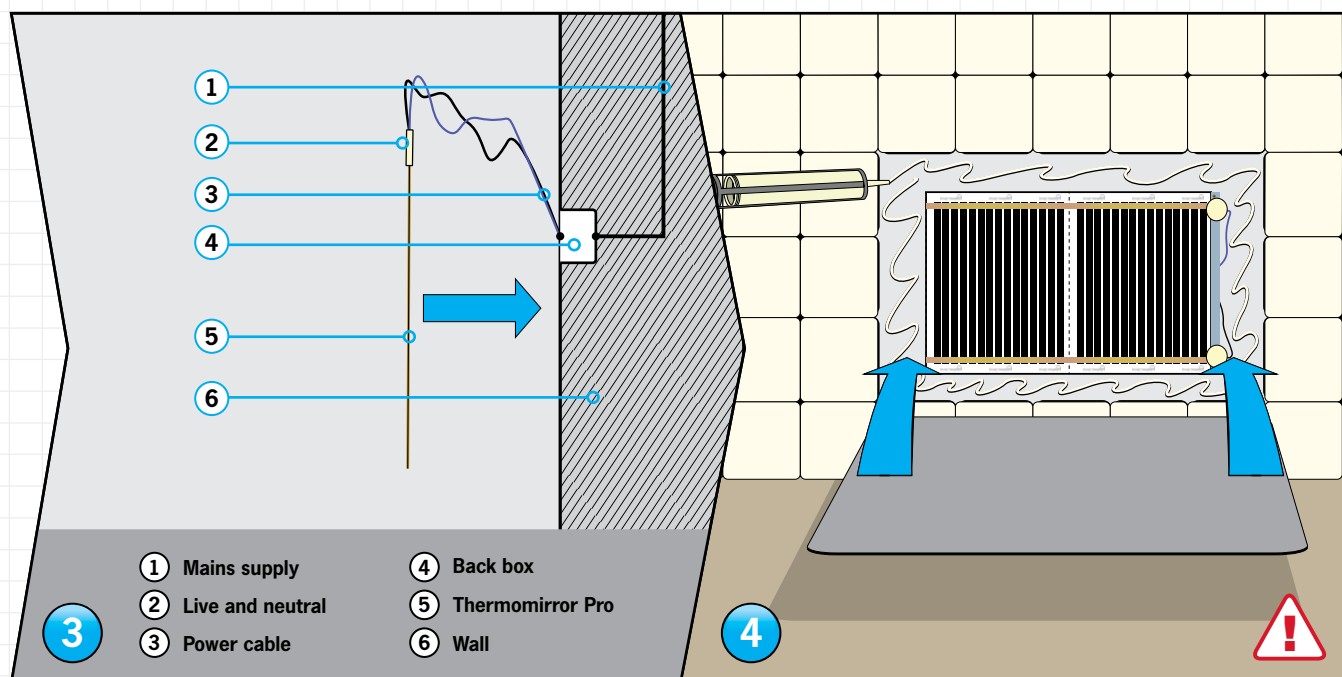

Step 3: Apply the heating element to the wall

Connect Thermomirror to the lighting circuit in accordance with the wiring diagram opposite. Electrical connections must be concealed in accordance with relevant safety standards. Use a back box if required.

Fix Thermomirror to the wall using the self adhesive strips or Mir-o-bond adhesive (5320). Ensure any surplus connection wire is concealed and as tidy as possible to allow easy mirror installation.

We recommend to leave at least 100mm spacing around Thermomirror to allow enough room for adhesive and/or mechanical fixings.

✓ PRO TIP

On larger mirrors multiple Thermomirror pads can be used and must be wired in parallel.

✓ PRO TIP - Trimming Thermomirror Pro

If necessary Thermomirror Pro can be trimmed to size on site. Simply measure and trim to the desired length in a straight line. Re-insulate the end with a double layer of insulation tape. Please note only make cuts parallel to the black strips and never across them.

Step 4: Fix mirror to your wall

Fix the mirror to the wall using mechanical fixings, Mir-o-bond adhesive or a combination of both. If using Mir-o-bond please adhere the mirror directly to the wall. Do not rely on the bond between Thermomirror and the mirror.

Thermomirror can be used behind mirrors in a wet zone if the mirror is fully sealed against water ingress on all edges and around fixing holes (if applicable). This seal can usually be achieved by using a high quality gunnable silicone sealant.

✓ PRO TIP

To avoid damage to the mirror, do not over tighten fixings and ensure that no point pressure is applied to the mirror.

Step 3 & 4 checklist:

- ☐ USE SILICONE ADHESIVE TO SEAL THERMOMIRROR AGAINST WALL
- ☐ TRIM AND INSULATE THERMOMIRROR IN LINE WITH INSTRUCTIONS (IF NECESSARY)
- ☐ SECURE WALL FIXTURES IF REQUIRED BUT DO NOT OVER TIGHTEN
- ☐ ENSURE ALL ELECTRICAL CONNECTIONS ARE SAFE

! IMPORTANT SAFETY PRECAUTIONS !



THERMOMIRROR IS IP54 RATED AND SHOULD BE USED IN CORRELATION WITH THESE REGULATIONS



ADHERE THE HEATER TO THE WALL, NOT THE BACK OF THE MIRROR



IF USING A METAL SURROUND, PLEASE ENSURE THE MIRROR IS GROUNDED ACCORDING TO LOCAL ELECTRICAL REGULATIONS

Technical Specification			
Stock No.	Product Name	Size (mm)	Output (W)
5300	Thermomirror PRO De-steamer Pads	W250 x H500	19
5301	Thermomirror PRO De-steamer Pads	W500 x H500	45
5303	Thermomirror PRO De-steamer Pads	W1000 x H500	90
5305	Thermomirror PRO De-steamer Pads	W1500 x H500	135
5312	Thermomirror PRO De-steamer Pads	W250 x H300	11
5314	Thermomirror PRO De-steamer Pads	W500 x H300	22
5316	Thermomirror PRO De-steamer Pads	W1000 x H300	45
5318	Double Sided Tape	W25 x L5000	N/A
5320	Mirobond Adhesive 310ml	N/A	N/A
5322	Skeleton Gun	N/A	N/A

CONTACT US ONLINE



Browse our full product range, watch videos, download product literature and get a quote, all on the Thermogroup UK website.

WWW.THERMOGROUPUK.COM

CONTACT US BY PHONE



Got a question or query? Call our UK support line free from your land line.
Open 07:30 – 16:30 Mon - Fri

0800 019 5899

CONTACT US BY MAIL



Need to find us or want to write a letter to say hello? Feel free to contact us at Bridge House.

**Thermogroup UK, Bridge House,
Hop Pocket Lane, Paddock Wood,
Kent. TN12 6DQ.**



Thermogroupuk



SUSTAINABLE HEATING SOLUTIONS

**Thermogroup UK
Bridge House
Hop Pocket Lane
Paddock Wood
Kent
TN12 6DQ**

0800 019 5899

sales@thermogroupuk.com

www.thermogroupuk.com

E&OE © Thermogroup UK 2012